

ILLA DEL CEL. 2 BEDROOMS REFURBISHED FLAT WITH 18SQM TERRACE



FLAT FOR SALE IN BARCELONA - DIAGONAL MAR

Brand new refurbished flat, with large windows and plenty of natural light throughout the day. The current distribution of the apartment is an entrance hall, large living-dinning room with exit to a 18 sqm terrace, equipped kitchen, 1 master bedroom with en-suite bathroom and dressing area, 2nd bedroom with built-in wardrobes and 2nd bathroom. Parking space included in price.

Some of the finishes are, ceramic floors with imitation wood, top of the range kitchen with NEFF appliances, aluminium carpentry with double glazing and hot/cold air-conditioning by means of ducts. For more convenience, there is a large parking space on the property itself.

ILLA DEL CEL is a high standing residential complex in the privileged area of Diagonal Mar - Front Maritim, located by

CHARACTERISTICS

LOCATION

REF. 29029



132 M2

2

2



711.000 €

ESCALA DE LA CALIFICACIÓN ENERGÉTICA		Consumo de energía kWh/m²/año	Emissiones de CO2 kg/m²/año
A	Más eficiente		
B			
C			
D		62	13
E			
F			
G	Menos eficiente		

TAKE
A LOOK
360°





SUPERFICIES ÚTILES (m²)							
1	Cocina / Office	12.47	5	Baño 1	4.30		
2	Salón / Comedor	25.82	6	Baño 2	3.16		
3	Habitación suite	14.87	7	Distribuidor	10.50		
4	Habitación 2	9.77	8	Terraza	17.58		
SUPERFICIE ÚTIL TOTAL		98.25	SUPERFICIE CONSTRUIDA		132.49		

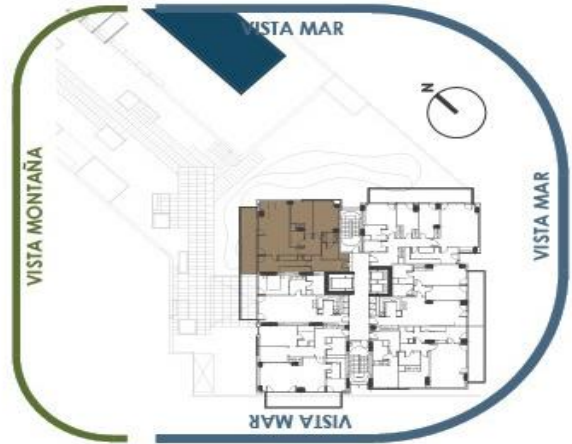

ILLA DEL CEL BARCELONA



DIAGONAL MAR TOWERS
ILLA DEL CEL

TORRE A - Planta 1 a 16 puerta 6ª

*Este plano no constituye documento contractual. La información que contiene es orientativa y de carácter general.